

NOTES:

- 1) TRACK LOCK SCREW AND MICROMETER CLAMP ACCEPT 5/64" (2.0) ALLEN WRENCH
- 2) ENGLISH MOUNTING HOLES ON 1/2" GRID. METRIC MOUNTING HOLES ON 12.5MM GRID
- 3) FOR MOUNTING HOLE LOCATION REFER TO DRAWING 9064-X

7X 1/4-20 (M6)

1.00 (25.4)

2X ALIGNMENT HOLES FOR 5/64 (2.0) ALLEN WRENCH

8X 8-32 (M4)

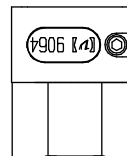

1.25 (31.8)

2.50 (63.5)

1.25 (31.8)

2.50 (63.5)

ACCEPTS DIA .375 (9.5) ACTUATORS

.62 (15.7)

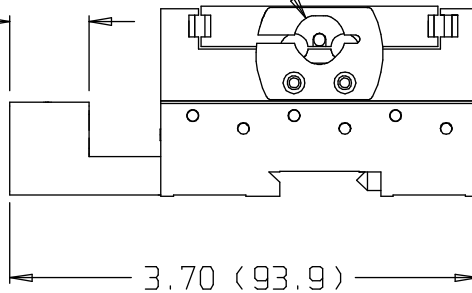

3.70 (93.9)

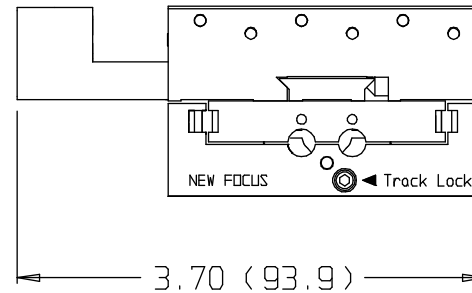

1.50 (38.1)

3.70 (93.9)

9064-XY-R(M) TRANSLATION STAGE

 New Focus™